

1	CUSTOMER		MVA	
---	----------	--	-----	--

2	OIL	MINERAL	ESTER	SILICON	OTHER:
---	-----	---------	-------	---------	--------

3	SERVICE TYPE	POWER PLANT	NETWORK	ELECHTROLYSIS	MOBILE UNIT
	NO SUITABLE FOR NUCLEAR PLANT	FURNACE	WIND-TURBINES	CONVERTER	OTHER:

4	ENVIROMENTAL CONDITIONS	NORMAL	OTHER:
---	-------------------------	--------	--------

5	N° PHASES	1-PHASE	3-PHASES	OTHER:
---	-----------	---------	----------	--------

6	N° COLUMNS	1	2	3	6	OTHER:
---	------------	---	---	---	---	--------

7	N° STAGE	SINGLE	DOUBLE	OTHER:
---	----------	--------	--------	--------

For this section, see Annex A

8	TYPE OF CONNECTION:	BRIDGE	LINEAR	Y/Δ	S/P	OTHER:
---	---------------------	--------	--------	-----	-----	--------

9	VOLTAGE CLASS (kV)	72,5	100	123	145	170	245
---	--------------------	------	-----	-----	-----	-----	-----

10	CURRENT (A) max for each contact	
----	----------------------------------	--

11	REGULATION FOR STEP:	≤ 2,5%	OTHER	
----	----------------------	--------	-------	--

12	TEST VOLTAGE	"AC" power frequency for 1min.	"BIL" Lightning impulse 1.2/50μs
----	--------------	--------------------------------	----------------------------------

12a	Between adiacent Contact		
-----	--------------------------	--	--

12b	Between First and last contactS		
-----	---------------------------------	--	--

12c	To ground		
-----	-----------	--	--

12d	Between phases		
-----	----------------	--	--

12e	Between two contacts groups		
-----	-----------------------------	--	--

12f	Between commons in case of inversion polarity		
-----	---	--	--

12g	other (please specify)		
-----	------------------------	--	--

13	N° POSITIONS:	
----	---------------	--

14	N° STEPS:	
----	-----------	--

For this section, see Annex B

15	TYPE CONTACTS:	CAP:	SAL:	B:	(model 025)
----	----------------	------	------	----	-------------

		KC:	KRC:	KS:	KRS:	(model 030)
--	--	-----	------	-----	------	-------------

16	SILVER PLATED CONTACTS:	NO	YES:	FIXED	MOVING	COMMON
----	-------------------------	----	------	-------	--------	--------

all tap changers with current ≥ 600 A have silver plated contacts

For this section, see Annex C

17	ASSEMBLING DETAILS:	1A	1B	3A	4A	5A
----	---------------------	----	----	----	----	----

BASIC CONNECTION FOR RECTILINEAR OFF-CIRCUIT TAP CHANGERS

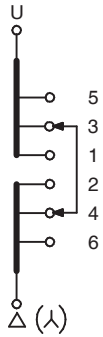

BRIDGE CONNECTION
TYPES: AT-MT-MTV-K-KL

(A)

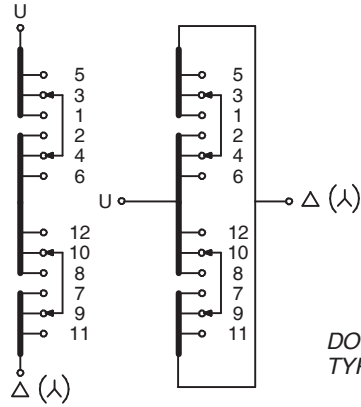

DOUBLE BRIDGE CONNECTION
TYPES: AT-MT-MTV-K-KL

(B)

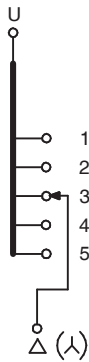

LINEAR CONNECTION
TYPES: ATC-MC-MRV-KR-KLD

(C)

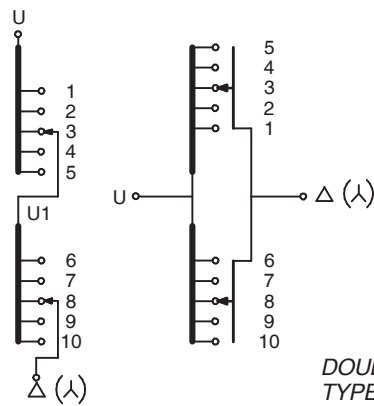

DOUBLE LINEAR CONNECTION
TYPES: ATC-MC-MRV-KR-KLD

(D)

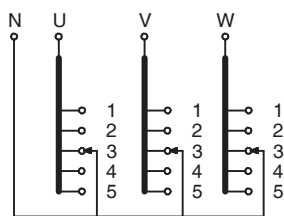

WYE (STAR) CONNECTION
TYPES: ATS-MS

(E)

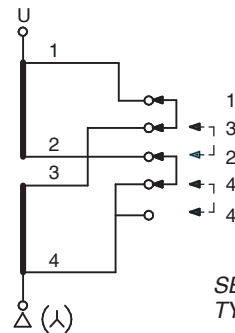

SERIES / PARALLEL CONNECTION
TYPES: ATSP-MSP-KLSP1020

(F)

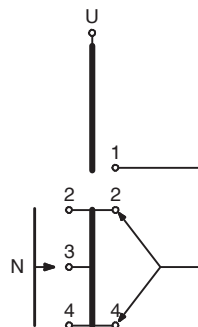

LINEAR CONNECTION WITH REVERSING SWITCH
TYPES: MRV-KR

(G)

FIXED CONTACTS ONLY FOR SERIES 025

THREADED CONTACTS

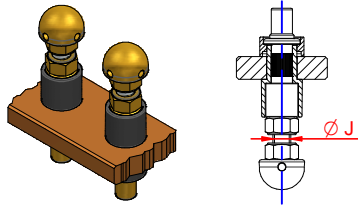

	TYPE	MAX. CURRENT	ØJ	MATERIAL
<input type="radio"/>	CAP 120	120 A	M8	Brass
<input type="radio"/>	CAP 200	200 A	M10	Brass
<input type="radio"/>	CAP 300	300 A	M12	Brass
<input type="radio"/>	CAP 400	400 A	M14	Brass
<input type="radio"/>	CAP 600	600 A	M16	Copper

TUBULAR CONTACTS

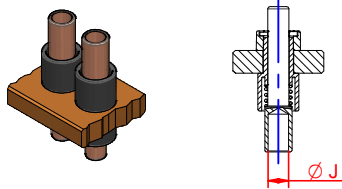

	TYPE	MAX. CURRENT	ØJ	MATERIAL
<input type="radio"/>	SAL 180	180 A	11	Copper
<input type="radio"/>	SAL 330	330 A	13,5	Copper
<input type="radio"/>	SAL 420	420 A	15,5	Copper

FLAG CONTACTS

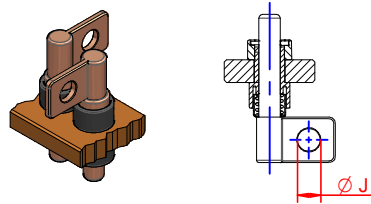

	TYPE	MAX. CURRENT	ØJ	MATERIAL
<input type="radio"/>	B 30	400 A	13	Copper
<input type="radio"/>	B 40	400 A	15	Copper
<input type="radio"/>	B 60	600 A	13	Copper

FIXED CONTACTS ONLY FOR SERIES 030

THREADED CONTACTS

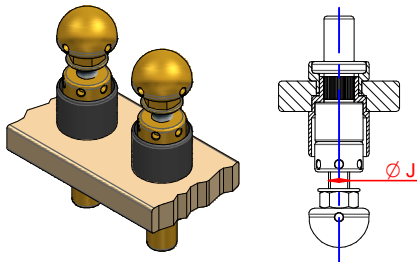

	TYPE K	TYPE KR	MAX. CURRENT	ØJ	MATERIAL
<input type="radio"/>	KC 200	KRC 200	200 A	M10	Brass
<input type="radio"/>	KC 350	KRC 350	300 A	M12	Brass
<input type="radio"/>	KC 500	KRC 500	500 A	M14	Brass
<input type="radio"/>	KC 800	KRC 800	800 A	M20	Copper

TUBULAR CONTACTS

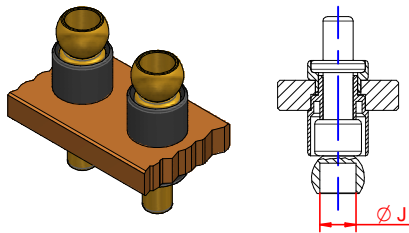

	TYPE K	TYPE KR	MAX. CURRENT	ØJ	MATERIAL
<input type="radio"/>	KS 200	KRS 200	200 A	16	Brass
<input type="radio"/>	KS 350	KRS 350	300 A	19	Brass
<input type="radio"/>	KS 500	KRS 500	500 A	24	Brass

ONLY FOR SERIES 025 SPECIFY

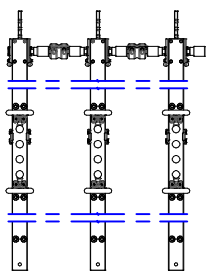

STANDARD
(With fixed contacts in front)

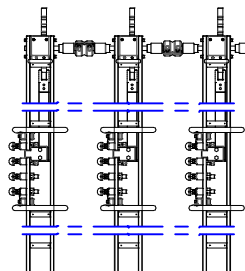

TURNED CONTACTS 90°
(Inform the item on assembling diagram SPT)



1A

- (fixed contacts to right)
- (fixed contacts to left)



1B

- (fixed contacts to right)
- (fixed contacts to left)



2A

- (fixed contacts to right)
- (fixed contacts to left)



2B

- (fixed contacts to right)
- (fixed contacts to left)

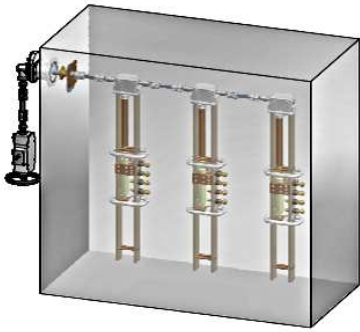

3A

- (fixed contacts to right)
- (fixed contacts to left)

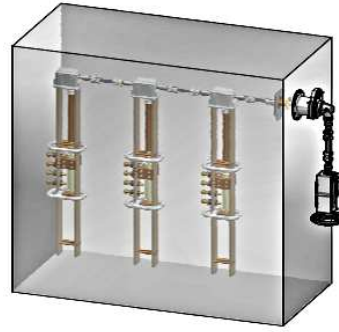

3B

- (fixed contacts to right)
- (fixed contacts to left)

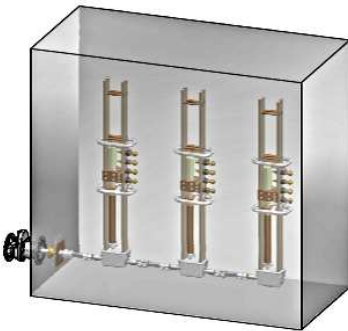

4A

- (fixed contacts to right)
- (fixed contacts to left)

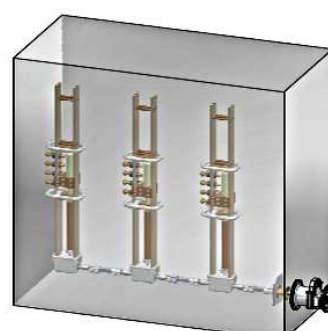

4B

- (fixed contacts to right)
- (fixed contacts to left)

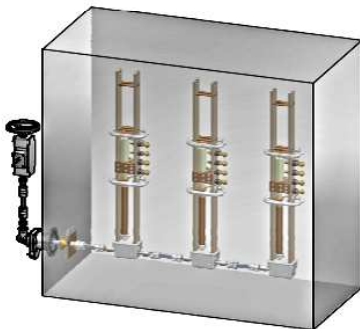

5A

- (fixed contacts to right)
- (fixed contacts to left)

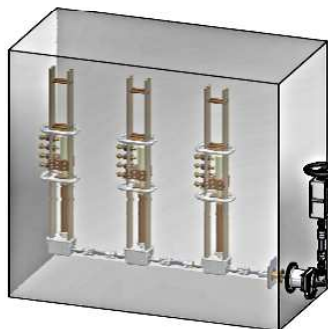

5B

- (fixed contacts to right)
- (fixed contacts to left)